



INSTALLATION INSTRUCTIONS

Product: Adjustable Sway Bar Links

Part Number: JKS2031, JKS2035

Applications: Wrangler JK, 2007+

517-278-1226 • jks@sporttruckusainc.com • www.jksmfg.com
491 W. Garfield Avenue, Coldwater, MI 49036

Welcome

CONGRATULATIONS on purchasing a set of new Adjustable Sway Bar Links from JKS Manufacturing. We are committed to providing you with the best products available and your satisfaction is our first priority.

PLEASE READ these Installation Instructions carefully, and save them for future reference, as they contain important installation and maintenance information.

Tools Required

- Metric/Standard Socket Wrench Set
- Torque Wrench
- Medium Strength Threadlocker
- Tape Measure
- Angle Measuring Tool
- 15/16" Open-End Wrench
- 18mm & 19mm Open-End Wrenches *
- Grease Gun with Zerk Fitting Coupler
- Wheel Bearing Grease
- Factory Service Manual (recommended)

* Asterisk denotes tools that are not required for some applications. Thoroughly read instructions first to determine which tools will be required for your application.

Parts

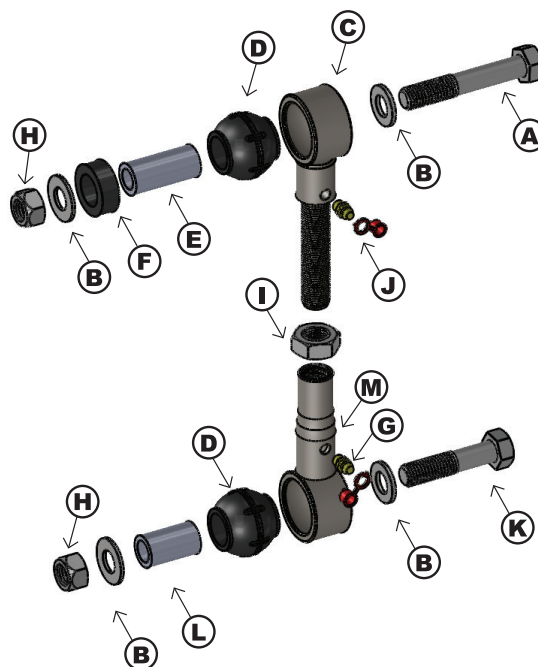

A	1/2"-13 x 3" Bolt
B	1/2" SAE Flat Washer
C	Upper Male Threaded End
D	Spherical Polyurethane Bushing
E	0.750 x 0.120 x 1.650 Sleeve
F	Offset Polyurethane Spacer
G	Grease Zerk Fitting
H	1/2"-13 Lock Nut
I	5/8" Jam Nut
J	Grease Zerk Cap
K	1/2"-13 x 2-1/4" Bolt
L	0.750 x 0.120 x 1.255 Sleeve
M	Lower Female Threaded End

Important Product Safety Information

For your safety and the safety of others, please read all instructions and warnings in this pamphlet and your Jeep® owner's manual and off road driving supplement before attempting installation. Within these instructions the following signal words refer to important product safety information:

WARNING

Indicates hazards or unsafe situations which could result in **severe personal injury or death**.

CAUTION

Indicates hazards or unsafe situations which could result in property damage or minor to moderate personal injury.

NOTICE

Careful attention is required to this operation that generally does not relate to personal injury, although damage to your JKS product or other property may result if you fail to follow instructions.

WARNING

Higher Rollover Risk

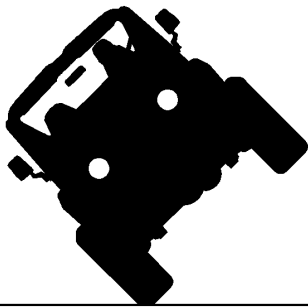

Modifying your Jeep® to improve off-road performance may result in vehicle handling different than as factory equipped, including increased ride-height and/or chassis articulation; reduced lateral stability and higher risk of roll-over or other accident. Also, owner's choice of larger tire and wheel combinations may require additional braking force or increased stopping distances.

To reduce risk of serious injury and accident:

- Choose modifications that balance your actual highway & off-road use.
- Avoid sharp turns, abrupt maneuvers or steep side-cambers.
- Avoid other maneuvering conditions which may cause the vehicle to trip, roll, lose traction or compromise your ability to safely brake in an emergency.
- Routinely inspect your vehicle components for unusual wear or off-road damage. Repair or Replace any unserviceable components before use.
- Do not modify or combine body lifts with other mechanical lifts contrary to manufacturers' or Jeep® recommendations & warnings.
- Acquaint any other drivers with your vehicle modifications and handling.
- Always wear seat belts and/or appropriate off-road restraints, reduce your speed, Tread Lightly®.

Important

NOT COMPATIBLE WITH aftermarket swaybars.
Install product with Original Equipment swaybar only.

SOME VEHICLES MAY REQUIRE extended front brake hoses or other modifications to compensate for additional suspension travel.

NEVER DISCONNECT swaybar when operating vehicle on public roads.

W

WARNING

Stay Connected On-Road

On-highway safety is enhanced by controlling body roll. Never disconnect swaybar when operating on public roads.

Installation

- 1. PREPARE VEHICLE**
 - Park the vehicle on a clean, level surface and block the rear wheels.
- 2. REMOVE FACTORY SWAY BAR LINKS**
 - Disconnect and remove the factory sway bar links from the vehicle. The factory links and hardware will not be reused.

❑ 3. DETERMINE ADJUSTABLE SWAY BAR LINK LENGTHS

- Determine the Ideal Swaybar Angle for your vehicle according to the following chart.
- With the proper sway bar angle determined, measure the distance between the sway bar link mounting holes at the axle and sway bar. Record that measurement below. Vehicle must be at normal ride height and located on level ground.

➡ Sway Bar Link Length: _____

CAUTION

Max. length is based on required thread & jam nut engagement. Measure & DO NOT extend the Adjustable Sway Bar Links beyond maximum length of your part number (bushings center to center).

Vehicle	Part Number	Maximum Length *	Ideal Swaybar Angle (Acceptable Range)
JK Wrangler	PN 2031	7-1/8"	0° (-5° to 5°)
	PN 2035	11-5/8"	

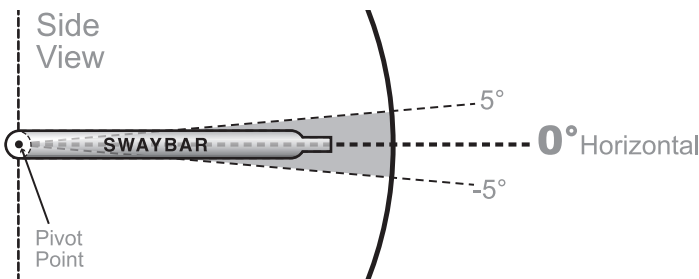

❑ 4. SET ADJUSTABLE SWAY BAR LINK LENGTHS

- The new JKS adjustable sway bar links are packaged pre-assembled. Remove the links from the package and determine which is the driver's and passenger's side links. The male adjustable end will mount to the sway bar with the polyurethane spacer mounting to the outside face of the sway bar end. The grease fittings will face out toward the front of the vehicle

- Adjust the length of the JKS Adjustable Sway Bar Links to the recorded value determined in step 3. Be sure to measure from the centers of each bushing with the bushings square to the link eyes.
- Once adjusted, lay links on a flat surface and tighten 5/8" Jam Nuts firmly against the Lower Ends.

IMPORTANT: Bushing eyes at both ends of Adjustable Sway Bar Links must remain parallel with each other when Jam Nut is tightened.

❑ 5. INSTALL ADJUSTABLE SWAY BAR LINKS

- Be sure that the longer sleeve and polyurethane spacer are installed on the top and towards the sway bar, as shown in the figure below.
- Locate the driver's side sway bar link. Position the male adjustable end will mount to the sway bar with the polyurethane spacer mounting to the outside face of the sway bar end. The grease fittings will face out toward the front of the vehicle
- Loosely attach the sway bar links to the outside face of the sway bar with the provided 1/2" x 3" bolts, nuts and washers.

Note: In some cases a rotary grinder may be necessary to slightly open up the sway bar hole to clear the 1/2" bolt. This ensures a tight fit.

- Loosely attach the axle end of the sway bar link to the inside face of the axle mount tab with the provided 1/2" x 2-1/4" bolts, nuts and washers.
- With both the upper and lower ends loosely attached, torque the mounting bolts to 65 ft-lbs.



If you encounter any problems with your installation and setup, please contact JKS Manufacturing for technical assistance.

JKS Technical Support

Phone	517-278-1226
E-Mail	jks@sporttruckusainc.com

Troubleshooting

If swaybar does not rotate freely, remove from vehicle, clean and apply rubber lubricant to chassis-mounted bushings, and reinstall.

Maintenance

It is important to lubricate the Adjustable Sway bar Links frequently for the first three (3) months after installation to evacuate contaminants that may build up during break-in period.

After break-in period, the Adjustable Sway Bar Links should be lubricated regularly as part of vehicle maintenance schedule.

Regular cleaning with pressurized water is recommended to maximize ease of operation and reliability. Always lubricate afterwards to evacuate any moisture.

❑ 6. LUBRICATE ADJUSTABLE SWAY BAR LINKS

- Lubricate all Grease Zerk fittings on the Adjustable Sway Bar Links immediately after installation using common wheel bearing grease or equivalent.

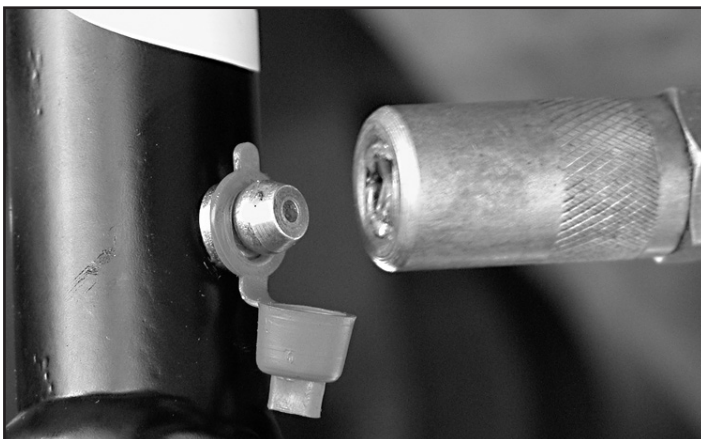

©2014 JKS Manufacturing, Inc & Aftermarketing, LLC
Revision Date 1/21/2021